

Bedminster Down Road

B E D M I N S T E R

APPROXIMATE FLOOR AREA
58.1 SQM / 626 SQFT



GROUND FLOOR
318 sq.ft. (29.6 sq.m.) approx.

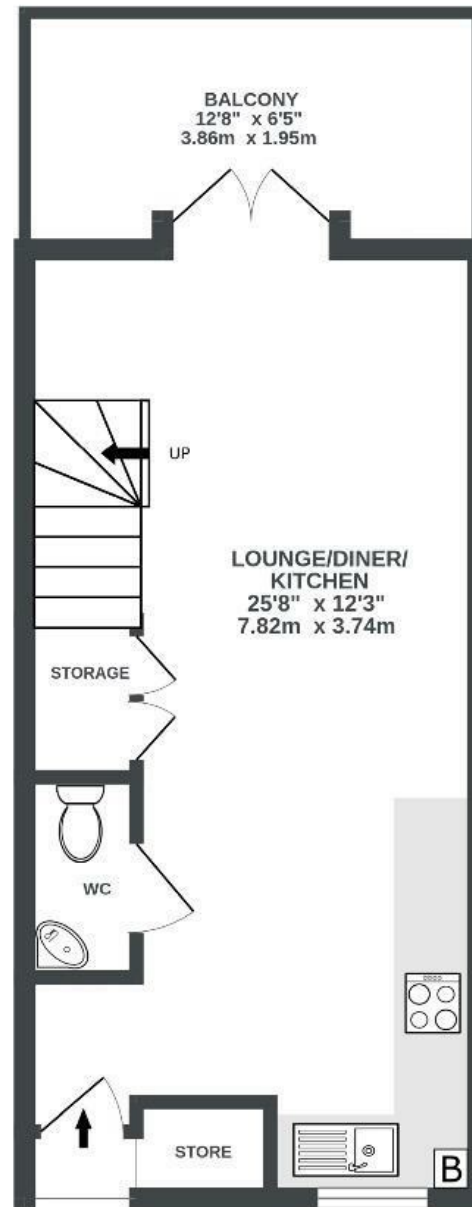

1ST FLOOR
307 sq.ft. (28.5 sq.m.) approx.

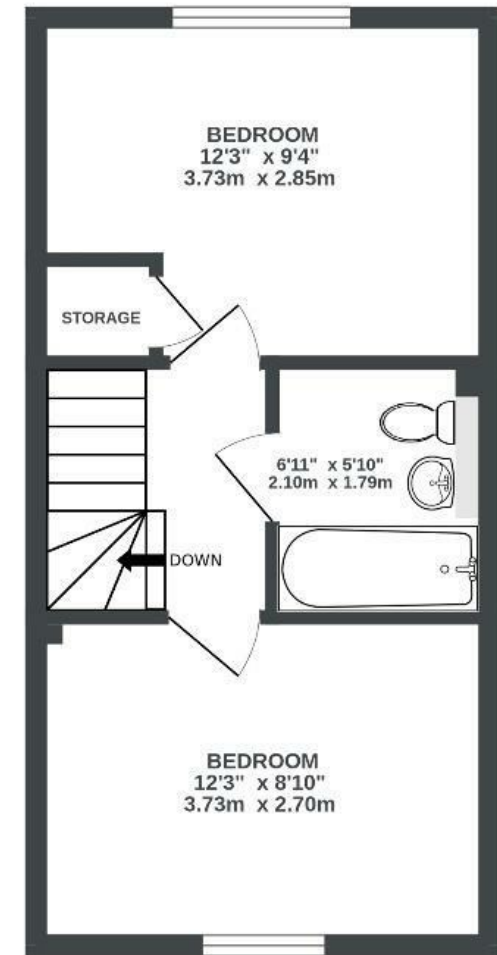

Illustrations are for reference purposes only, measurements are approximate, not to scale.

~~Boardwalk~~

Bedminster

, BRISTOL

£

£275,000



Bristol, BS13

7AF

zzz

2 Bedrooms



1 Bathrooms

"I'm really going to miss waking up to such a beautiful view each morning. Waving at hot air balloon enthusiasts as they fly over the house has always made me smile. On a sunny afternoon, I've loved swinging in my hammock on the balcony and watching the birds come and go. I've been lucky enough to have fledglings in the birdhouse for the last 3 years now!"

The open plan living area has been ideal for hosting my friends and family for dinner, drinks or games nights. I have thoroughly enjoyed making home improvements, from simple decorating to boarding the loft. Having the bus stop right outside and Parson Street station only a few minutes walk down the road, has been really helpful for getting to work or social events in the centre. There is always plenty going on in Bedminster. One of my highlights includes sitting on the balcony with a glass of wine, whilst listening to Elton John and numerous other artists play at Ashton Gate Stadium. I have loved going to Zion for brunch and spend a lot of time on North Street at the cafes and little

